



# Swimwear Spin Dryer

Type: OD 100, Model: B 250-1



## IMPORTANT:

READ CAREFULLY BEFORE USE. KEEP FOR FUTURE REFERENCE.

### Notice to Installer:

This document contains important information about the installation, operation and safe use of this product – this information **must** be read before the installation and start-up of this product. Once the product has been installed this document must be given to the owner/operator of this equipment.



# Table of contents

Content:	Page No:
Product conformity information	2
Safety notices	3 – 4
About the product	4 – 5
List of supplied components	5
Installation	6 – 13
Operation	13 – 14
Maintenance & cleaning	14 – 17
Troubleshooting	18 – 19

## Product conformity information

This item complies with the following European Directives:

2006/42/EU – Machinery Directive

2014/30/EU – Electromagnetic Compatibility Directive

2011/65/EU – RoHS Directive

Bamiko s.r.o.  
Bezručova 663, 756 61 Rožnov pod Radhoštěm, CZ  
IČO: 0252909  
Zapsáno v obchodním rejstříku, vedeném Krajským soudem v Ostravě,  
oddíl C, vložka 57912  
Tel.: +420 737 456 238  
www.bamiko.cz, e-mail: info@bamiko.cz



**ES (EU) CONFORMITY DECLARATION**

**Manufacturer:** BAMIKO s.r.o.  
Bezručova 663, 756 61 Rožnov pod Radhoštěm, Czech Republic

**Product:** Swimwear Spin Dryer (SuitSpin by Bamiko)  
**Type:** OD 100  
**Model:** B 250-1  
**Serial number:** xxxxxxxxxx  
**Production Year:** xxxx

**Description of the appliance:**  
Swimwear Spin Dryer is designed for water extraction from a swimwear at swimming pools and other aqua establishments. Swimwear Spin Dryer is designed for self-operation.  
Main part of the Swimwear Spin Dryer is the inner drum with the lid, extraction process begins by closing the lid. The inner drum stops automatically at a set time interval or when the lid is opened.



**Product is in compliance with all applicable standards:**  
European directive 2006/42/CE (Government regulation No. 176/2008 Sb.) – Machinery Directive  
European directive 2014/30/EU (Government regulation No. 117/2016 Sb.) – EMC Directive  
European directive 2011/65/EU (Government regulation No. 481/2012 Sb.) – RoHS 2 Directive

**Used harmonized standards:**  
ČSN EN 50569:2014 + A1:2018  
ČSN EN 55014-1 ed.3:2007 +A1:2010 +A2:2012 +Z1:2017  
ČSN EN 55014-2 ed.2:2017  
ČSN EN 61000-3-2 ed.4:2015 + Z1:2019  
ČSN EN 61000-3-3 ed.3:2014 + A1:2019

**Authorized to compile the technical documentation:**  
Bamiko s.r.o., Bezručova 663, 756 61 Rožnov pod Radhoštěm, Czech Republic

**The product is safe under standard and intended operation.**  
The Engineering Test Institute, s.p., Hudcova 56b, 621 00 Brno, Czech Republic  
has tested/ certified the product and has issued: Certificate no. MD-J-00416-20 on 13.3.2020.  
The Military Technical Institute s.p., Václavské náměstí 691, 682 01 Vytkov, Czech Republic  
has tested/ certified the product and has issued: Test reports 194300-663/2019, 194300-679/2019 on 3.12.2019.

**The manufacturer declares that its swimwear spin dryer meets all relevant regulation of the European Union, as listed above.**

**The last two digits of the year in which the CE marking was affixed:** 20  
Place of Issue, Date: In Rožnov p. R., on 13.03.2020  
Identification of the person with authorisation to sign for the manufacturer: Ing. Ondřej Miller  
executive head  
Signature:   
  
www.bamiko.cz  
BAMIKO s.r.o.  
Bezručova 663  
756 61 Rožnov pod Radhoštěm  
CZ  
IČO: 0252909  
DIČ: CZ0000000000

### Manufacturer:

Bamiko s.r.o.  
Bezrucova 663  
756 61 Rožnov pod Radhoštěm  
Czech Republic

### Importer:

Certikin International Ltd  
Witan Park, Avenue Two  
Station Lane Industrial Estate  
Witney  
Oxfordshire  
OX28 4FJ  
United Kingdom  
Tel: ???? (suitspin number)



## Safety notices

SuitSpin by Bamiko is designed and manufactured in compliance with all relevant international safety standards. Product installation which is contrary to this manual, improper use of the device, inadequate cleaning of the device or improper repair of the device, could lead to personal injury and product damage.

**TO AVOID POSSIBLE HARM, READ AND FOLLOW THESE INSTRUCTIONS. RETAIN THESE INSTRUCTIONS FOR FUTURE REFERENCE. IT IS ADVISABLE TO KEEP THESE INSTRUCTIONS IN CLOSE PROXIMITY TO THE DEVICE.**



This notice signifies a hazard with a **HIGH** level of risk which, if not avoided, **WILL** result in death or serious injury.



This notice signifies a hazard with a **MEDIUM** level of risk which, if not avoided, **COULD** result in death or serious injury.



This notice signifies an **ELECTRICAL** hazard with a **HIGH** level of risk which, if not avoided, **WILL** result in death or serious injury.



This notice signifies an **ELECTRICAL** hazard with a **MEDIUM** level of risk which, if not avoided, **COULD** result in death or serious injury.



This notice signifies a hazard with a **LOW** level of risk which, if not avoided, **COULD** result in minor or moderate injury.



This notice signifies a potential risk of damage to the product or property.

**⚠ WARNING** This equipment must be installed and maintained by qualified persons only. Improper installation and maintenance can create electrical and mechanical hazards which could result in property damage, serious injury or death. Improper installation and servicing will void the warranty.

**⚠ WARNING** A qualified electrician must carry out all electrical wiring in accordance with local electrical regulations.

**⚠ WARNING** SuitSpin is to be used according to the content of the supplied instructions and is suitable only of **ONE** piece of swimwear at a time. Any other use is considered contrary to the supplied instructions and can be dangerous.

**⚠ WARNING** Before each use, check that the drum is empty and intact.

**⚠ WARNING** Children and people with reduced physical, sensory or mental abilities should only use the product under the supervision of a responsible adult.

**⚠ WARNING** If SuitSpin is visibly damaged, or you have any concerns over the safety of the device, **DO NOT USE** until the issues have been resolved.

**⚠ WARNING** Do not remove the protective cover of the device

**⚠ CAUTION** Never pour water inside the device – this can result in insufficient drainage within the device which can damage the motor.

The manufacturer or importer are not liable for any damage or injury caused by incorrect installation or incorrect use of this product.

## About the product

SuitSpin by Bamiko is an innovative Czech designed product especially designed to extract water from a single piece of wet swimwear. SuitSpin should not be used for any other drying or spinning purpose and should not be used to dry multiple pieces of swimwear.

The device will gently extract up to 95% of the water held within a piece of swimwear, thus offering an enhanced customer experience at a low operating cost whilst at the same time significantly reducing the amount of water and moisture within changing areas which in turn prolongs the life of fixtures and fittings.

Suitspin is easy to install, use and maintain and is made from high quality materials such as chemical resistant stainless steel and highly durable plastics.

Each SuitSpin carries its own unique serial number (on the product label positioned at the bottom left hand side of the unit) for full traceability.

 **WARNING** A qualified electrician must carry out all electrical wiring in accordance with local electrical regulations.

Benefits and features of SuitSpin:

- Easy and intuitive operation
- Easy and fast maintenance
- Easy and fast installation
- Short 10 second cycle time
- Built in motor with electromagnetic break
- Build in RCD
- Manual start and stop
- Uses no heat
- Can be connected to coin/token payment if desired
- Added value and increased comfort for visitors/users
- Great selection of colours and designs
- Environmentally friendly
- Compact dimensions
- Helps to prolong the life of wet leisure facilities
- Optional water collection tank



Once expired, this product should not be disposed of via general waste, but through a regulated waste disposal and recycling centre – please consult your local authority for full advice.

# Technical information

Product Name:	SuitSpin by Bamiko
Type:	OD 100
Model:	B 250-1
Voltage:	1N~230V/50-60Hz
Noise Level:	<70 dB
Total Power: Idle In operation	0.003 kW 0.21 kW
Cycle Time:	10 seconds
Weight: Product itself Including packaging materials	22 kg 25 kg
Dimensions: Height Width Depth	555 mm 350 mm 300 mm
Waste Connection: Drain hose length Inner diameter Outer diameter	Approx. 0.7m 25 mm 31 mm
Safety Features: Built-in RCD Safety mechanical end switch IP66 glands IP65 junction box	Built-in motor thermal protection IP54 motor P65 electrical box 5A fuse

*The manufacturer reserves the right to make any changes in the technical parameters which do not affect the functionality of the product*

## List of supplied components

- Transport box, packaging materials, transit bar for motor protection
- SuitSpin unit (with 2.5 attached power cable + approx. 0.7m drain hose)
- Operating instructions for the unit lid and for wall mounting
- Safety screw driver
- Cleaning bottle brush
- Wall bracket
- Securing bracket
- Wallplugs and fixings
- User manual – full details (this document)
- Individual protected documents regarding installation, daily, weekly and monthly cleaning – **please keep near by the product to aid with regular cleaning and maintenance or product removal**

**NOTICE:** Please retain all packaging materials, including the motor transport bar and fixings, in the event that the unit should ever need to be returned for repair.

# Installation

## General information

Remove all packaging, including protective parts and motor transit bar (see page 8), before attempting installation. **Keep all of the packaging materials, including the transit bar and its fixings in case the dryer needs to be returned or transported. In the event of returning or transporting the device, the transit bar and all protective packaging MUST be re-established in order to prevent damage. Transporting or returning the dryer without the transit bar or protective parts will void the warranty.**

 **WARNING** If SuitSpin is visibly damaged, or you have any concerns over the safety of the device, **DO NOT INSTALL OR USE** until the issues have been resolved.

 **WARNING** This equipment must be installed and maintained by qualified persons only. Improper installation and maintenance can create electrical and mechanical hazards which could result in property damage, serious injury or death. Improper installation and servicing will void the warranty.

 **WARNING** A qualified electrician must carry out all electrical wiring in accordance with local electrical regulations.

 **WARNING** Check that the product voltage (on the product label) is the same as the power supply.

 **WARNING** Always work in such a way which will not damage the power cord. In the event of damage to the power cord please consult with a qualified electrician.

## Suitable location

Suitspin should only be installed and used in dry or slightly humid environment. Installing the product in a high humidity environment will shorten its life. The ambient temperature at the installation point must be lower than 35°C.

SuitSpin must be installed a minimum of 3 metres away from any water sources that can splash onto it. It must not be installed directly next to a swimming pool or spa, in shower rooms or in other places where water may come into direct contact with the unit.

The ideal locations are areas where bathers remove their swimwear, such as changing rooms and drying rooms. Alternatively, the unit can be installed outside of changing rooms, in access corridors or at any other place where users may have safe access, but it should not be installed in areas where it can restrict free passage.

SuitSpin must be installed onto a wall which can take a minimum of 30kg of hanging weight – installation onto plasterboard walls is not recommended. If a water collection container is also to be installed, the wall must hold at least 50kg of hanging weight. These parameters cover the weight of the machine and the water container in normal use – consideration has not been given to the possibility of added weight or pressure applied by users.

The power supply should be in the vicinity of the installation location – the unit comes with 2.5m of pre-wired cable.

Consider and decide how waste water will be removed as part of deciding the installation location. The drain hose can be connected directly to a waste outlet in the wall, connected or placed nearby a drain or can be connected to a SuitSpin water collection container (supplied separately). **The drain hose must be directed downwards along its full length – it must not bend or twist.** If in doubt, consult a qualified plumber.

# Installation onto the wall

## Required tools and equipment

- Suitable masonry drill with masonry drill bit (8mm)
- Spirit level
- Tape measure (minimum 2m)
- Marker pen
- 7 x wall plugs 8x50mm – supplied
- 7 x stainless steel screws 5 x 60mm – supplied

**⚠ WARNING** When using power tools always refer to the instructions and information provided with that piece of equipment and always wear appropriate PPE.

## Installation process

1. After selecting a suitable place for installation, place the wall bracket against the wall so that the top edge is **900mm from the floor**. Make sure that the bracket is level using the spirit level and mark the 6 holes using a marker pen. Drill the holes and fit the wall plugs. Align the wall bracket with the holes, make sure it is level and fix it securely using the supplied screws. The positioning of the bracket will result in the top edge of the dryer being 1080mm from the floor.

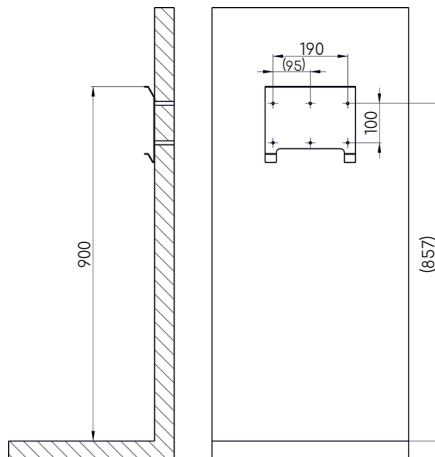

2. Make sure the transit bar is removed from underneath the product. If not removed, the dryer will not work correctly.

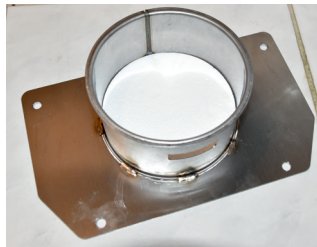
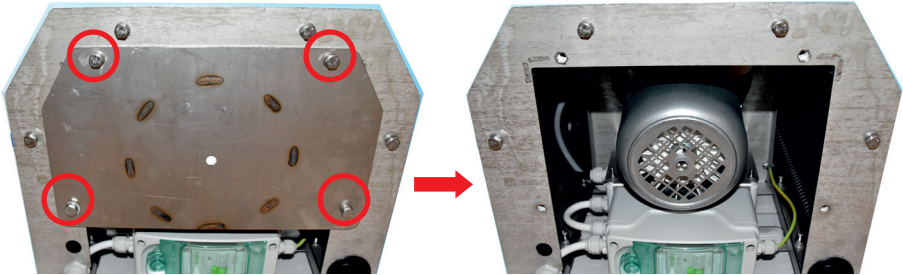

Transit Bar

3. Place the dryer on the wall bracket and push on the top so that the dryer sits securely on the bracket. There should be no gap between the dryer and the wall and the unit should be vertical and level.



4. Unscrew the two screws (identified by the red arrow) at the bottom edges of the dryer and using the same screws, fix the securing bracket (as shown by the green arrow).

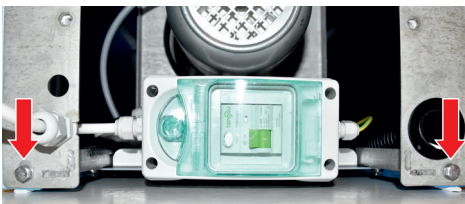



5. Mark a point on the wall through the hole in the securing bracket (red arrow). Remove the dryer from the wall. Drill a hole at the marked point, insert the wall plug, place the dryer back on the wall bracket, push the top so it sits securely on the bracket and fix the securing bracket firmly to the wall using the supplied screw.

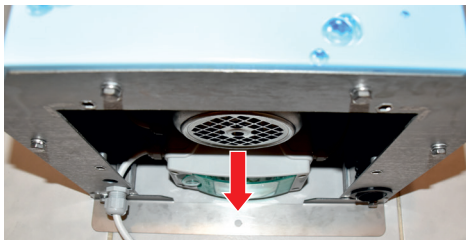

6. Pull the waste hose fully out of the bottom of the dryer (green arrow).

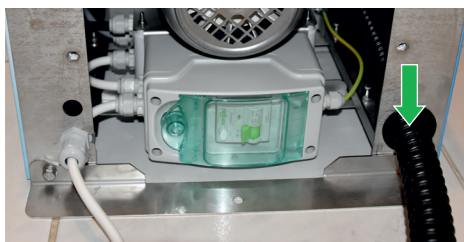

7. Install the operating instruction plaque on the wall, directly above the dryer, so that the top edge of the plaque is 1650mm from the floor.

### Optional - installation process of the water container

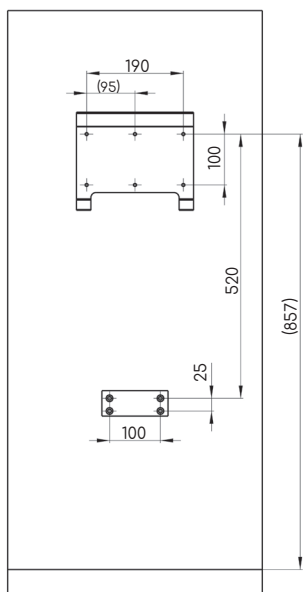
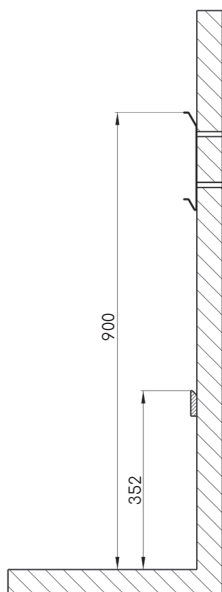

1. After following these instructions, the bottom edge of the water container will be 136mm from the floor. Make sure that there are no obstacles on the wall that would prevent the installation of the water container. Otherwise, adjust the recommended heights to your needs.
2. Create a vertical centre line from the position of the dryer mounting bracket. Position the water container bracket on the wall so that it is central to this line and the top edge is 352mm from the floor. Ensure the bracket is level. Mark four holes through the bracket, drill the holes and fix the bracket to the wall with the plugs and screws provided.
3. Place the water container onto the bracket and make sure it is secure. The top edge of the bracket will be 386mm from the floor.

## Wastewater disposal

**! NOTICE** Installation must be completed in accordance with all applicable local plumbing codes and regulations. If in doubt, consult a qualified plumber.

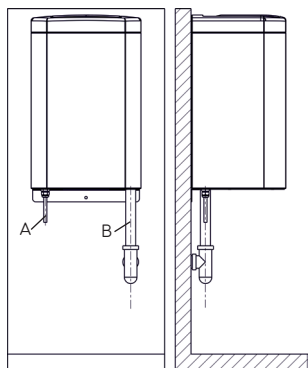

### 1. Connection to a waste line

Shorten the drain hose (B) according to the position of the waste point. **The hose must not be bent or twisted and must always slope downwards** in order to provide adequate water disposal. Not following this instruction could result in insufficient flow of water which could cause unpleasant odours and damage to the product.

Insert the drain hose into the waste point. If in doubt, consult a qualified plumber.

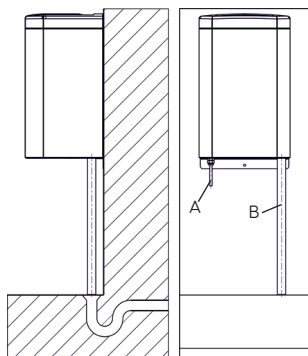

### 2. Connection to a floor drain

The drain hose (B) can be connected to or placed near a floor drain.

Shorten the drain hose according to your needs, **ensuring that the hose is not bent or twisted**. The drain hose must be placed in such a way that it does not create an obstacle for people walking by.

In the case where the drain hose is in the vicinity of a floor drain, as opposed to directly above, or directly connected, it is recommended that the hose end is cut to an angle of 45° to maintain a free flow of water and to prevent blockage. (This type of waste scenario should **ONLY** be used in places where people expect water to be on the floor).

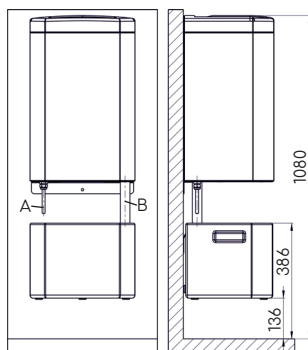

### 3. Connection to a water container

The drain hose can be connected to a SuitSpin water container which would be mounted on to the wall underneath the dryer (see page 10).

The capacity of the water container is 18 litres and it needs to be emptied manually.

After installation of the dryer and water container, shorten the drain hose so that it extends 50-100mm below the top of the water container. Place the drain hose through the hole in the top of the container and **ensure it is not bent or twisted**. The hole within the container will hold the hose in place.

This installation is **ONLY** suitable for walls which will hold a minimum of 50kg hanging weight.

## Electrical connection

**⚠ WARNING** A qualified electrician must carry out all electrical wiring in accordance with local electrical regulations.

After installing the dryer correctly onto the wall, it can be connected to the power supply (L – live wire – brown / N – neutral wire – blue / PE – ground wire – green/yellow). All electrical connections must be made by a qualified electrician and in accordance with local electrical codes and regulation.

Your SuitSpin is now ready to be used.

### OPTIONAL – CONNECTION OF THE DRYER TO A COIN MACHINE/CHIP SYSTEM

**⚠ WARNING** A qualified electrician must carry out all electrical wiring in accordance with local electrical regulations.

The SuitSpin is ready to be connected to a coin machine/ chip system. You can connect it to any system that you are currently using or one that is available in your location as long as it meets the following requirements:

- A timer that can be set for 20 seconds and that switches on after inserting a coin/ introducing a chip to the reader
- Connecting the system with the SuitSpin using a 2-wire cable with potential free signal (recommended wire diameter 2 x 1 mm)
- You should only use a system with such a voltage to ensure safety of operation. The system must be in compliance with all applicable local electric codes and regulations

#### Connection steps:

- We recommend installing the coin machine / chip system on a wall next to the dryer
- Pull the cable with potential free signal out of the coin machine/ chip system, pull it through PG11 gland (not supplied) and fix the PG gland to the stainless-steel plate at the bottom of the dryer
- Unscrew the end cup gland from the electrical box and install a PG7 gland (not supplied) into the same hole. Pull the cable through the gland and into the electrical box. We recommended fixing the cable to the inner side of the electrical box
- Connect the cable with potential free signal to the terminal blocks marked as "INT" and "GND", see the wiring diagram below
- On the mother board, move the blue switch marked as "I" up to the "ON" position, the dryer will now receive the potential free signal from your system
- Should you want to temporarily disconnect the coin machine / chip system, simply put the blue switch on the mother board marked as "I" back down to the "OFF" position

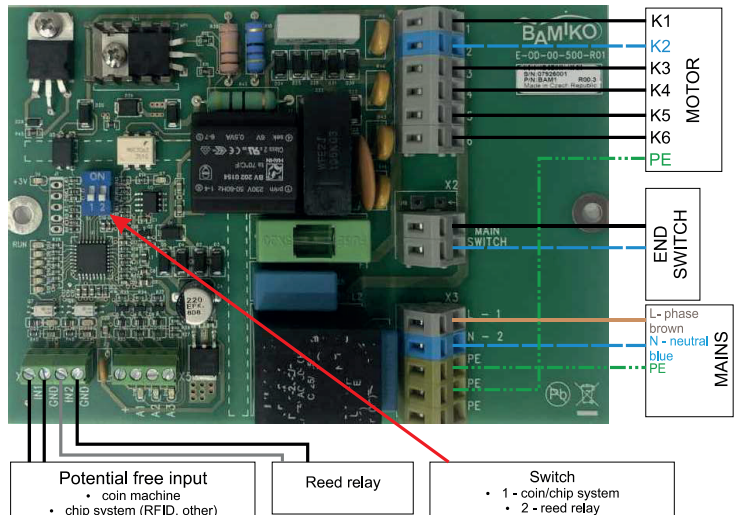

# Operation

## Before first use of the dryer

After connecting the SuitSpin to the electrical supply, and when you are ready to use it, ensure that the RCD at the bottom side of the dryer is in the ON "I" position.

Before first use, make sure the inner drum is intact and that the dryer has not been damaged in any way during installation.

## General operation

 **WARNING** Before each use, check that the drum is empty and intact.

 **WARNING** Children and people with reduced physical, sensory or mental abilities should only use the product under the supervision of a responsible adult.

 **WARNING** If SuitSpin is visibly damaged, or you have any concerns over the safety of the device, DO NOT USE until the issues have been resolved.

Operation of SuitSpin is extremely simple and safe.

1. Do not use the dryer unless the drum is stationary
2. Place a **SINGLE PIECE** of swimwear into the drum – make sure any strings are facing downward
3. Make sure the swimwear is entirely **UNDER THE BRUSH SEAL**, otherwise it could get damaged
4. Close the lid and hold it down for 10 seconds – the inner drum will rotate, extracting the water from the swimwear. A break will apply after 10 seconds, or if the lid is opened, and stop the drum. If the dryer vibrates excessively, lift the lid and re-position the swimwear more evenly
5. When complete, remove the swimwear from the dryer

If a water collection tank is being used, regularly inspect the volume of water within the tank and empty as required.

# Maintenance & cleaning

SuitSpin is designed to require low levels of maintenance, however, all mechanical and electrical appliances require some attention. Following these easy, periodical cleaning and maintenance instructions will help to avoid future problems, prolong the life of the dryer and offer higher customer satisfaction.

Daily, weekly and monthly cleaning is recommended in places with chlorinated water and with less than 200 customers per dryer per day. In cases that the water is more aggressive (iron, sulfur, salt) or with more customers per day, it is recommended that the frequency of the cleaning regime is increased.

 **WARNING** During any maintenance and cleaning routines, the SuitSpin should be isolated from its power supply.

 **CAUTION** Never pour water inside the device – this can result in insufficient drainage within the device which can damage the motor.

## Daily routine

Isolate the power supply.

1. Clean the inner drum with a disinfectant. Spray the disinfectant inside the drum and let it work. Then wipe it using a soft cloth.

**After cleaning reestablish the power supply and test the unit:**

2. Insert a wet swimsuit/cloth inside the drum and run the cycle. Extracted water must exit through the waste hose freely and must be clear. All extracted water should go through the waste hose, if the water runs down the engine and drops from the bottom of the dryer, your waste hose is clogged. In that case, immediately clean the waste hose or install a new one (see page 17).
3. When running the cycle, make sure that the engine starts immediately, the cycle time is 10 seconds and the engine stops instantly (in less than 1 second).

## Weekly routine

### Cleaning:

Isolate the power supply.

1. **Clean the outside cover and plastic parts** using a soft cloth. Use lukewarm water with mild detergent, or products especially suited for the cleaning of stainless-steel, plastic or painted surfaces. Plastic parts must not be cleaned with products that contain alcohol or that are flammable or abrasive.
2. **Clean the inner drum with a disinfectant.** Spray the disinfectant inside the drum and let it work. Then clean it thoroughly using a soft cloth.

**After cleaning reestablish the power supply and test the unit:**

3. Check the waste hose by inserting a wet swimsuit/cloth inside the inner drum and running the cycle. Extracted water must exit through the waste hose freely and must be clear.
  - a. Should the water be dirty, repeat the procedure several times, until the water is clear. If it does not help, dismantle and clean the waste hose or replace it with a new one.
  - b. Should the water run slowly or not at all, the waste hose is more likely clogged. In that case, dismantle and clean the waste hose, or replace it with a new one (see page 17).

## Technical inspection:

### Isolate the power supply.

1. Check that the inner drum is intact and that it does not lean to one side. If the drum leans to one side, a shock absorber might be broken. In that case, contact your supplier and inform them about it.
2. Check that the protective bristle ring is fixed properly to the top of the inner drum and that the ring is intact. In the case of damage to the bristle ring, contact your supplier and order a replacement.

### Reestablish the power supply and test the unit:

3. Close the lid and run the cycle.
  - a. After closing the lid, the motor must start immediately. If the engine does not start immediately or takes more than 3 seconds to start spinning, check for any possible obstacles between the inner and outer drum.
  - b. Make sure that the timer is working correctly, the cycle time should be 10 seconds.
  - c. Make sure that the engine stops immediately (in less than 1 second) when the cycle is complete or anytime when the lid is opened. If the engine takes longer to stop, contact your supplier as your brake might need adjustment or be worn.

## Monthly routine

### Isolate the power supply.

1. **Clean the outside cover and plastic parts** using a soft cloth. Use lukewarm water with mild detergent, or products especially suited for the cleaning of stainless-steel, plastic or painted surfaces. Plastic parts must not be cleaned with products that contain alcohol or that are flammable or abrasive.
2. Unscrew the 4 screws in the white plastic plate using the supplied screwdriver, keep the screws. Remove the plate, check that the springs are attached to the black plastic tube and that they are intact. Clean the white plate using a disinfectant and a soft cloth.
3. Remove the stainless-steel band and clean it using disinfectant and a soft cloth.

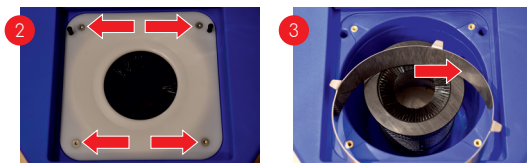

4. Check the space between the inner and outer drum and make sure that there are no foreign objects present – if so, remove. Make sure that the hose connection outlet at the bottom of the outer drum is not clogged. In case of a blockage, clean it thoroughly. Spray the space between the drums using disinfectant and let it work. Then clean the space thoroughly using the supplied bottle brush.
5. Make sure that there are no foreign objects present inside the inner drum – if so, remove. Spray the inner drum using disinfectant and let it work. Then clean the drum thoroughly using a soft cloth. Make sure that the bristle ring is properly fixed on the top of the inner drum and intact. In the event of damage, contact your supplier and order a replacement.



6. Put the stainless-steel band back inside the outer drum and make sure that the 4 bent parts are facing the brass nuts (as seen in the picture).
7. Install back the white plastic plate by screwing in the 4 previously removed screws, make sure that the springs fit inside the 2 holes. Test that the springs are strong enough to open and hold the lid.

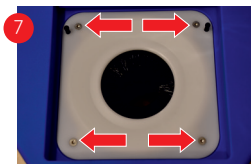
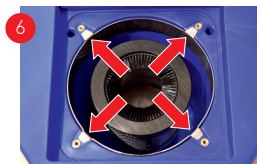

**After cleaning reestablish the power supply.**

8. On the underside of the dryer locate the junction box with RCD. Open the plastic door and press the "TEST" button.
9. The RCD's switch must move to the "OFF" position. Move the switch back to the "ON" position to resume normal function. If the switch does not move to the "OFF" position during testing or is unable to be moved back to the "ON" position, the RCD may be faulty. Please contact your Suitspin supplier.

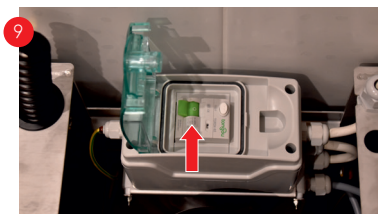
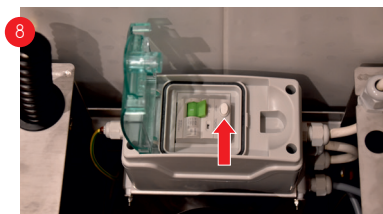

10. Insert a wet swimsuit/cloth inside the drum and let the cycle run. This will remove the remaining disinfectant. At the same time check that the extracted water exits freely through the waste hose and that it is clear. If not, the waste hose must be cleaned or replaced with a new one (see below).
11. Make sure that the engine stops immediately (in less than 1 second) when the cycle is complete or anytime when the lid is opened. If the engine takes longer to stop, contact your supplier as your brake might need adjustment or be worn.

#### REMOVING/CLEANING/REPLACING THE DRAIN HOSE:

**Isolate the power supply.**

The drain hose is connected to the outer drum waste port on the underside of the machine. Unfasten the jubilee clip which holds the hose to the port and slide off the hose. The hose can then be cleaned with the supplied bottle brush. Re-fix the hose, using the same jubilee clip, back onto the drain port.

**Reestablish the power supply and test the unit.**

# Troubleshooting

**⚠ WARNING** Some solutions to symptoms and possible causes must only be actioned by qualified persons, in which case contact your supplier. These are in the right-hand column below.

ROUTINE

**⚠ NOTICE** Presumption is made that the cleaning and maintenance regimes within this document are known and understood



SPECIALIST

**⚠ WARNING** To be actioned by qualified persons only

**⚠ WARNING** Always disconnect the dryer from the power supply



SYMPTOM		POSSIBLE CAUSES AND SOLUTIONS	
SuitSpin does not operate	Motor doesn't buzz / brake doesn't click / end switch doesn't click	Check that the RCD is in the ON "I" position and that it does not trip.	Check that the power supply is live and correctly connected.
	Motor doesn't buzz / brake doesn't click / end switch doesn't click – the problem is long lasting	Check whether you can hear a click of the end switch when opening/closing the lid – if not the end switch may need adjustment – contact your supplier	
	Motor doesn't buzz / brake doesn't click / end switch doesn't click – the problem is occasional	Check that there isn't any foreign object in the space between inner and outer drum that could cause a friction (follow the monthly cleaning instructions).	Carefully check the motor temperature. The motor has integrated thermal protection that shuts down the engine when overheated. After cooling down the motor works again.  If it doesn't solve the problem, motor's bearings might be worn out.
	Motor does buzz / brake doesn't click		Your brake needs adjustment/ new friction plates. Contact your supplier.
	Motor does buzz / brake does click	Check that there isn't any foreign object in the space between inner and outer drum that could cause a friction (follow the monthly cleaning instructions).	



SuitSpin is making excessive noise	Immediately after installation	<p>Check that you removed the transit bar underneath the dryer.</p> <p>Check that the security bracket was properly installed.</p> <p>Visually check that the shock absorbers were not damaged in transit – remove the machine from the wall and inspect underneath.</p>	In case of damage contact your supplier and do not use the dryer until the problem is solved.
	In normal operation/ inner drum is tilted to one side	<p>Check that you removed the transit bar underneath the dryer.</p> <p>Check that the security bracket was properly installed.</p> <p>Visually check that the shock absorbers were not damaged in transit – remove the machine from the wall and inspect underneath.</p>	In case of damage contact your supplier and do not use the dryer until the problem is solved.
	In normal operation/ inner drum is not tilted to one side	<p>The users may not be operating the product correctly (unevenly inserted swimsuit, more swimsuits at a time, forbidden items).</p> <p>Try to evenly insert a swimsuit inside the drum and run the cycle. If the product is still noisy, try to run the cycle with drum being empty. In case the dryer is still noisy the inner drum or the shock absorbers might be damaged.</p>	In case of damage contact your supplier and do not use the dryer until the problem is solved.
SuitSpin is leaking from underneath	SuitSpin is leaking right after installation	<p>Check that the drain hose was pulled down entirely and that it is not bent inside the product.</p> <p>Check that the drain hose is always sloped down. Check that the SuitSpin/the wall mounting bracket is level. The wall mounting bracket cannot be tilted to the left as this could prevent the water from exiting to the drain hose.</p>	
	The water is not coming only from the drain hose	<p>Check that the drain hose is not clogged or damaged.</p> <p><b>Do not use the product until the drain hose is cleaned or replaced with a new one.</b></p>	Check that the waste outlet at the bottom of the inner drum is not clogged – contact your supplier

This image shows a single sheet of white paper with horizontal ruling lines. The lines are evenly spaced and run across the width of the page. There are no margins, text, or other markings on the paper.

[illegible]



### Manufacturer:

Bamiko s.r.o.  
Bezrucova 663  
756 61 Roznov pod Radhostem  
Czech Republic  
[www.bamiko.cz](http://www.bamiko.cz)

### Importer:

Certikin International Ltd  
Witan Park, Avenue Two  
Station Lane Industrial Estate  
Witney  
Oxfordshire  
OX28 4FJ  
United Kingdom  
[www.suitspin.co.uk](http://www.suitspin.co.uk)